

Air Flow Indicator

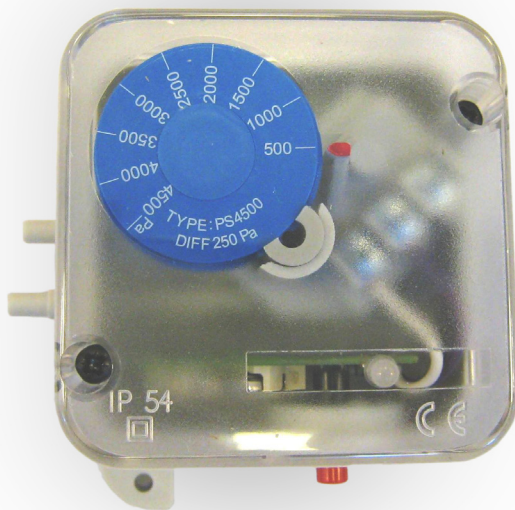

Air Flow Indicator (AFI) is now available as a new accessory. The AFI is a simple device that indicates when the airflow is adequate in a Nederman extraction arm. It can be installed on new as well as existing extraction arms installations.

- Battery driven pressure switch.
- Uses power only when you press the test button.
- **Must be calibrated on the field by a technician able to measure the air flow (using for example a DP-calc).**

Dimensions

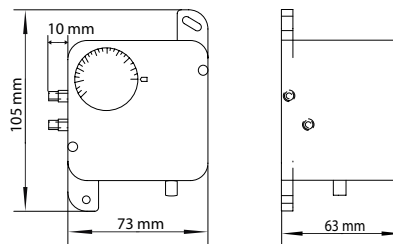

Technical Data

Pressure Range:	AFI 40-600 Pa = 40-600 Pa	
	AFI 500-4500 Pa = 500-4500 Pa	
Materials:	Housing	ABS
	Cover	PC
	Membrane	Silicone
	Duct connectors	ABS
	Tubing	PVC, soft
Connections:	Pressure connection	Male 5 mm
Weight:	150 grams (350 grams with accessories)	
Ambient and operation conditions:	Operation temperature -20...+60 °C	
	Storage temperature -40...+85 °C	
Maximum pressure:	50 kPa	
Admissible media:	Air and non-aggressive gases	
Safety:	IP Protection standard IP54	

Accessories (included as standard)

- 2 fixing screws
- 2 plastic duct connectors
- 2 m tube, dia 4 / 7 mm

Part no.	Description	Recommended mounting
10375373	Air Flow Indicator 500-4500 Pa	Over the local adjustment damper
10375374	Air flow indicator 40-600 Pa	In the swivel or in the hood

Mounting possibilities

The Air Flow Indicator needs to be placed indoors in a vertical position.

It can be put in three different places:

- Over the local adjustment damper (Recommended).
 - Measure of differential pressure
 - See picture (1).
- In the swivel.
 - Measure of static pressure
 - See picture (2).
- In the hood.
 - Measure of static pressure
 - See picture (3).

NOTE! If the AFI is placed in the swivel or in the hood, make sure that there is a damper (4) between the fan and the indicator. This is to secure that the calibration is done correctly.

